

ATLAS

BUILDING PRODUCTS

A MARMON BERKSHIRE HATHAWAY COMPANY

PRODUCT SPECIFICATION SHEET

#14 WOODTITE®



ASHLAND OHIO

1628 TROY ROAD
ASHLAND, OH 44805
(800) 321-6977

FLAT ROCK NORTH CAROLINA

161 COMMERCIAL BLVD
FLAT ROCK, NC 28731
(828) 692-2603

HOUSTON TEXAS

4822 N. SAM HOUSTON PKWY W.
SUITE 100
HOUSTON, TX 77086
(800) 503-2105

#14 WOODTITE®

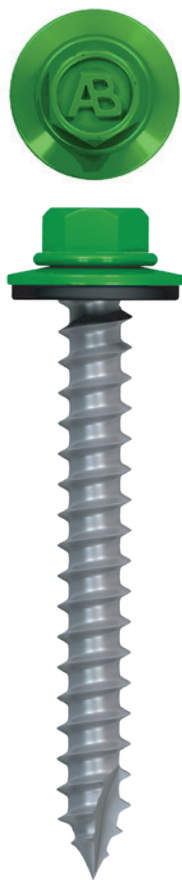

Head

5/16" hex head

Thread

Threads per inch: 10

Point

Type-17 sharp point to penetrate metal quickly while minimizing chips

Washer

Bonded sealing washer

Material

Carbon steel

Finish

Mechanically plated with long life coating

SIZE	ITEM #	BOX QTY
14-10 x 1	80613ZBN99XXHSL	2,500
14-10 x 1-1/2	80001ZBN99XXHSL	2,000
14-10 x 2	80009ZBN99XXHSL	1,500
14-10 x 2-1/2	82014ZBN99XXHSL	1,000
14-10 x 3	89016ZBN99XXHSL	1,000
14-10 x 3-1/2	14446ZBN99ZZHSL	500

STRENGTH CHARACTERISTICS (C1022)

MINIMUM TORSIONAL	MINIMUM TENSILE	MINIMUM SHEAR
125 in.-lbs.	3150 lbs.	2150 lbs.

PULL OUT VALUES

TEST MATERIAL	VALUES
SPF #2 (1 1/2 Penetration)	1,080 lbs.
7/16" OSB	213 lbs.
5/8" OSB	301 lbs.
1/2" CDX	520 lbs.
5/8" CDX	430 lbs.
3/4" CDX	718 lbs.

All test results and recommendations are based on laboratory tests. Specific job site conditions should be taken into consideration when specifying the proper fastener. Actual field values may vary, therefore we assume no liability for use of this information. Pull out values are a measurement of wood material strength. Use of impact style guns for installation not recommended.